



Electric truck - pedestrian stacker compact **ERV - 10**



-  **Multi-function tiller head**
-  **Mounted ergonomic tiller**
-  **Integrated charger**

The Electric truck - pedestrian stacker compact ERV - 10 combines performance efficiency and operator friendliness in one attractive design. It provides a multitude of utilisation possibilities for practically any application. For example: depositing goods on racking or feeding machines. Palletised goods are simply lifted to the required picking height and are then deposited in the racking without stressing the back or taken from the pallet.

The effortless handling of the ERV is facilitated by a number of ergonomic advantages: The tiller provides the operator with low steering forces and a high safety factor at the same time. All travel and lift functions are easily accessible from the multi-function lever. The narrow front length (455 mm) of the ERV ensures effortless operation even in confined spaces.

Recharging the ERV is also effortless by means of its integrated charger that can be connected to any 220 V mains socket. The battery discharge indicator continuously displays the battery condition.

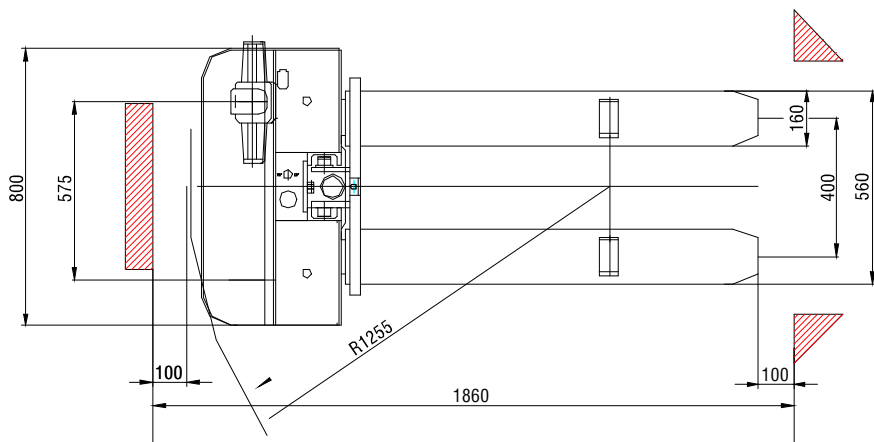
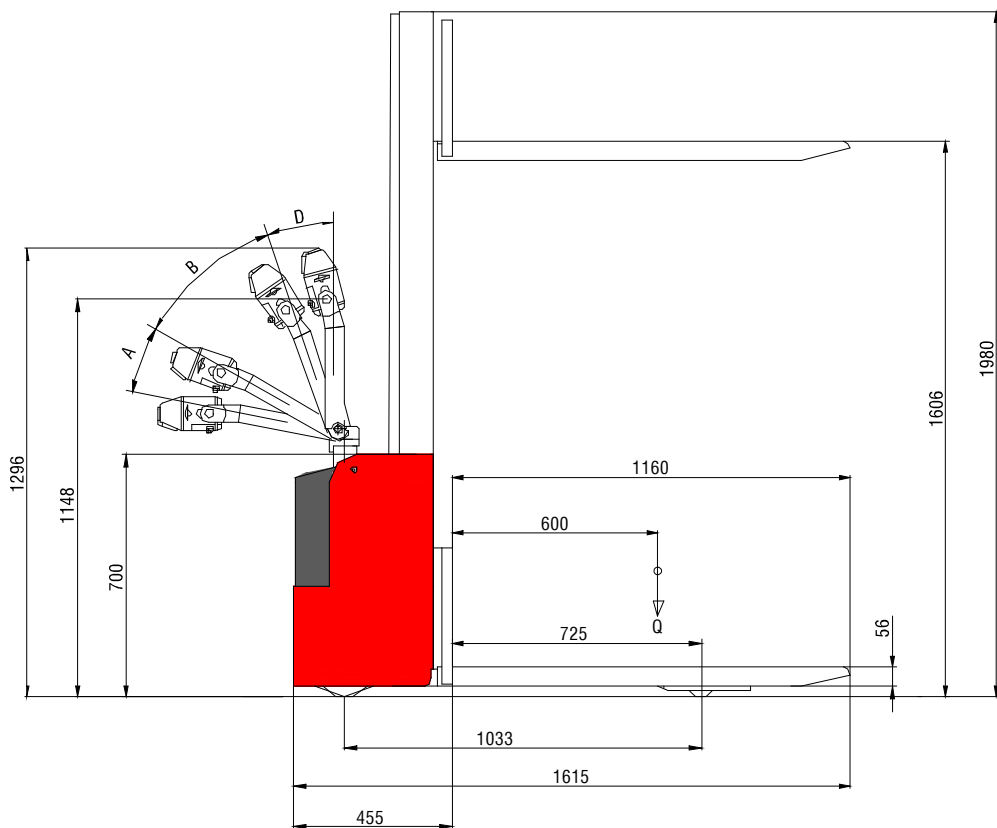

Load capacity		1000	kg
Lifting height		1600	mm
Height		1980	mm
Diameter of Motor-wheel		Ø 245 x 76	mm
Diameter of the supporting wheels		Ø 150 x 40	mm
Diameter of the rollers		Ø 82 x 90	mm
Moving speed	with/without load	3/3,6	km/h
Lifting speed	with/without load	0,06/0,12	m/s
Lowering speed	with/without load	0,16/0,15	m/s
Climbing ability		5/12	%
Parking brake		electric	
Working brake		electric	
Power of the electric motor for moving	S2-60 min	0,5	κW
Power of the electric motor for lifting	15% ED	1,5	κW
Accumulator battery		2 x 12 V/62	Ah
Charging device	24V/30A		impulse
Type of control			impulse
Degree of switching			without degree
Material of the whells/rollers			polyurethane/polyamide